

**Great Bear**  
Healthcare

***Drainage Bag***

***User Guide***

**Hello..**  
**We are Great Bear.**

**Dignity, Respect, Quality & Commitment.**

## Contents

Overview To The Libra Leg Bag	4
Connecting The Libra Leg Bag	6
Emptying The Libra Leg Bag	7
Suspensory Options And Where To Position	8
Different Types Of Leg Bag	9
GB Night Bags - Single Use	10
GB Night Bags - Reusable	11
Choosing A Night Bag	12
Overnight Link System	13
Using A Night Stand	14
Key Tips & Troubleshooting	15/16
Importance Of Catheter Fixation	17/18
Ordering Codes	19/20
Notes	21/22
Ordering Through Nightingale	23

**A UK Manufacturer committed to Urology.**

# Libra Leg Bag

Utilising high quality materials with a user friendly design, the Libra Leg Bag provides total peace of mind for users and carers alike.

With a comprehensive range of sizes and tube lengths, we are confident that there will be a Libra Leg Bag to suit all needs.

## Confidence, Security & Comfort.

## Key Features

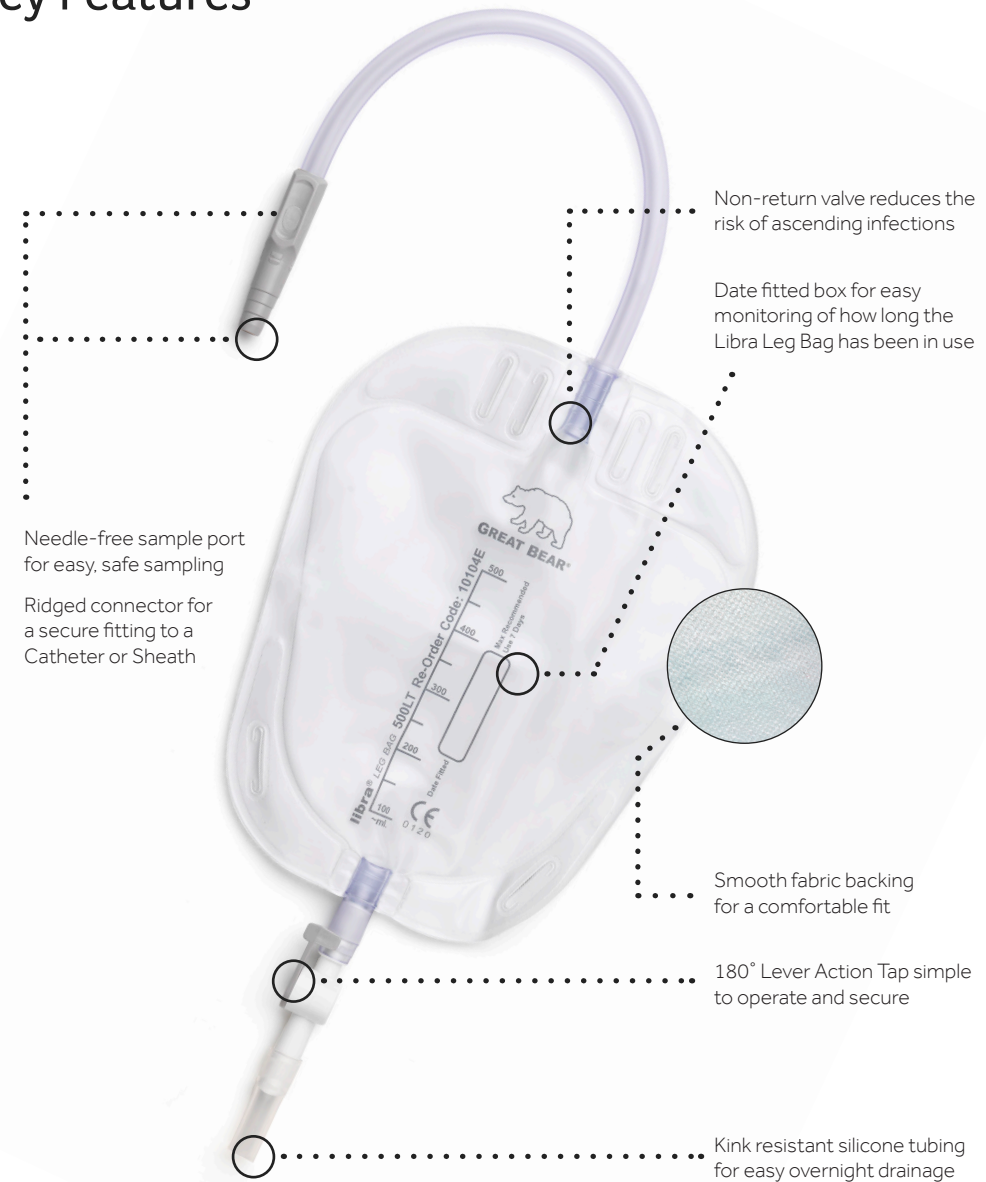

**Did you know...** The Libra Leg Bag tap can be swivelled for comfort and extra security. It also features raised ridges to allow the visually impaired to identify whether the bag is open or closed.

# How to connect the Libra Leg Bag to a Catheter or Sheath

- 1) Wash Hands.
- 2) Open peel pouch and remove Libra Leg Bag from its packaging.
- 3) Ensure the lever on the outlet tap is in the closed position (Diagram 2).
- 4) Remove the grey protective cap from the Libra inlet connector.
- 5) Insert the ridged inlet connector into the end of the Indwelling Catheter or Sheath. Insert the connector fully to allow a secure connection.
- 6) The Libra Leg Bag should be positioned on the thigh or calf, depending on the tube length, and secured appropriately with the leg bag straps provided – see page 8 for more information.
- 7) Feed the Leg Bag Straps through the eyelets on the bag and ensure the wavy silicone lines face onto the leg.
- 8) Make sure the inlet tubing isn't kinked which can restrict the flow of urine. Ensure you do not touch the open end of either the Catheter or Leg Bag Connector when connecting, emptying or changing the Leg Bag as this could lead to infection.

Diagram 1

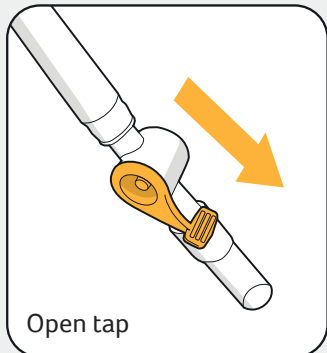
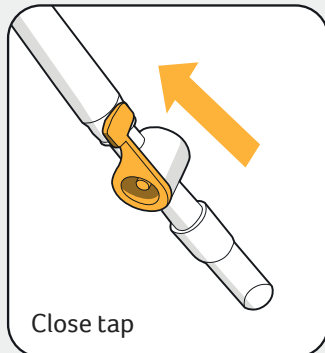

Diagram 2



# How to empty the Libra Leg Bag

Your Healthcare Professional will be able to advise you on how often you should empty your Libra Leg Bag. The frequency will depend on your urinary output and what capacity of Leg Bag you are wearing.

If unsure, empty your Leg Bag when it is two thirds full.

- 1) Wash Hands.
- 2) Empty the Libra Leg Bag by pushing the lever on the outlet tap all the way down to open (Diagram 1, Page 6).
- 3) Urine will flow from the outlet tap.
- 4) After remember to close the tap fully after emptying (Diagram 2, Page 6).
- 5) Wash hands.



# Suspensory Options & where to position

There are two main ways to support the weight of your Libra Leg Bag; Libra Leg Bag Straps or the Libra Leg Bag Holder.

Diagram 1

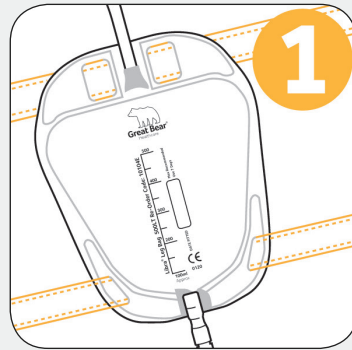
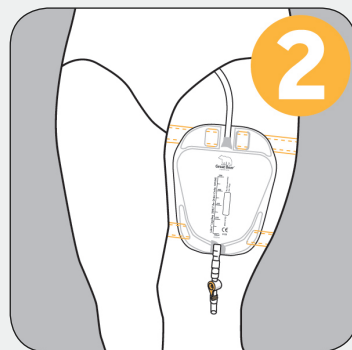

Diagram 2



**Important: Do not let your Leg Bag hang unsupported from your Catheter as this will cause urethral discomfort and trauma.**

## Libra Leg Bag Straps

Libra Leg Bag Straps support the Libra Leg Bag from the top and bottom and secure it comfortably to the leg.

The Libra Leg Bag will either be positioned on the thigh (if you are using a short tube or direct inlet) or on the calf (if you are using a long or adjustable tube).

- 1) Feed the longer Libra Leg Bag strap through the 4 eyelets at the top of your Leg Bag (Diagram 1).
- 2) Feed the shorter Libra Leg Bag strap through the 2 eyelets at the bottom of your Leg Bag (Diagram 1).
- 3) Ensure the silicone lines are facing your skin.
- 4) Wrap the straps around your thigh or calf in the desired position (Diagram 2).
- 5) Secure using the velcro tabs ensuring that the strap is not overtightened to prevent circulation in the leg.

## Libra Leg Bag Holder

Alternatively, you can use the Libra Leg Bag Holder which encases the Leg Bag on the leg, offering full support whilst allowing the skin to breathe.

# Different types of Leg Bag

As well as the standard Libra Leg Bag, Great Bear also offer the Libra Conform Leg Bag and Paediatric Leg Bag – ensuring that there is a Leg Bag suitable for individual patient needs.

## Libra Conform

Designed for maximum discretion and comfort, the Libra Conform is a three chambered Leg Bag that will wrap around the contour of the leg.

Ideal for those who are more active as the “ballooning” effect and audible noises associated with drainage bags are minimised as the urine is evenly distributed amongst the three chambers.

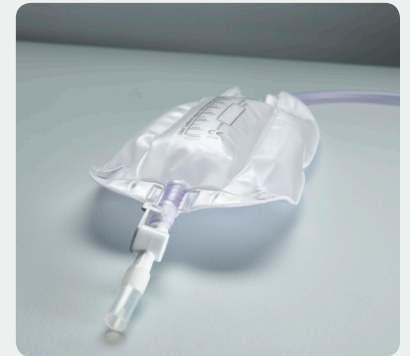

## Paediatric Bags

Mummy, Daddy and Baby Bear are designed specifically for babies and young children with a fun child-friendly appearance and less cumbersome sizes.

Mummy, Daddy and Baby Bear Leg Bags are recommended for babies and young children under the age of 5.



# GB Night Bag Range

## - Single Use

Our Night Drainage Bags can be connected to a Leg Bag to allow overnight drainage. The single use design means that, once emptied, they can be disposed of for ease and convenience.

### Key Features of the Single Use Night Bag Range

- 1) Drainable and non drainable designs available.
- 2) 2 litre and 3 litre capacities available.
- 3) Choice of both sterile or non sterile options.
- 4) 4 punched out hanger holes to allow positioning on a night stand.
- 5) Tear open strip on the GB2 and single use T tap on the GB3/GB3S allows for quick and easy emptying.
- 6) Tamper Proof – Our single use Night Bags cannot be reused after emptying.
- 7) A safety clip on the GB3, GB3S and GB5 protects the tap from accidental opening.
- 8) A universal design can be used with any leg bag.



**Important:** Do not connect a Single Use Night Bag directly to an Indwelling Catheter. Single Use Night Bags should only be connected to a Sheath or to a Leg Bag as part of an overnight link system (Page 13)

GB2



GB3



GB3S



# GB Night Bag Range

## - Reusable

The GB4, GB4 Fold Up and GB6 can be connected directly to a Sheath or an Indwelling Catheter and can be used for a period of 5-7 days. Do not reconnect a Night Bag or GB4 Fold Up after disconnecting from the Catheter.

### Key Features of the Reusable Night Bag Range

- 1) Sterile, Drainable Night Bags with our easy to use lever action tap.
- 2) 2 litre and 3 litre capacities available.
- 3) Flexible, wide bore tubing for easy drainage.
- 4) Date Fitted Box for easy monitoring of how long the Night Bag has been in use.
- 5) 4 punched out hanger holes to allow positioning on a night stand.
- 6) The tap on the GB4 Fold Up can be folded up to prevent prolonged contact with potentially contaminated surfaces.
- 7) A universal design can be used with any brand of Leg Bag.

GB4 Fold Up



GB4



# Which Night Bag is right for me?

GB Night Bags are designed with common features but also with specific benefits to suit individual needs. Here are some considerations to make when selecting a Night Bag:

## 1) **Do you wear a Leg Bag or Catheter Valve and need a Night Bag for additional drainage?**

If yes, a Single Use Night Bag would be beneficial. You connect it directly to your Leg Bag or Catheter Valve as part of an overnight link system (Page 13).

## 2) **Are you largely immobile or under bed rest?**

If so, one of the reusable options would be suitable as they can be connected directly to the Catheter and kept in situ for 5-7 days without a need for a Leg Bag.

## 3) **Are you susceptible to infections?**

Those who are more vulnerable or at risk of infection could benefit from our GB3S - a Night Bag that combines the infection control benefits of both single use and sterile options.



### **Remember**

Under no circumstances should any Night Bag be reused once the initial connection has been broken.



# Overnight Link System

Where a Leg Bag is being used, a 2 litre or 3 litre Night Bag can be connected to the end of the Leg Bag to provide additional capacity for overnight drainage.

- 1) When you go to bed, do not disconnect your Leg Bag from your Catheter or Sheath.
- 2) Insert the connector of your Night Bag to the silicone sleeve on your Leg Bag (Diagram 1). Insert the connector fully to allow a secure connection.
- 3) Once connected, turn the Libra Leg Bag tap to the open position (Diagram 2) to allow the overnight drainage into the Night Bag.
- 4) Before disconnecting the Night Bag in the morning, ensure the Libra Leg Bag tap is in the closed position (Diagram 3).



**The next night, use a new Night Bag – never reconnect a used Night Bag.**

Diagram 1

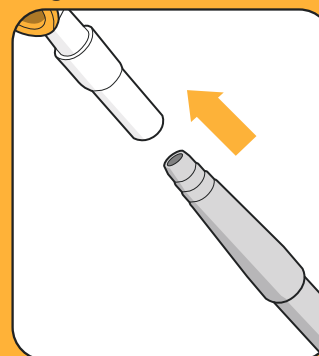

Diagram 2

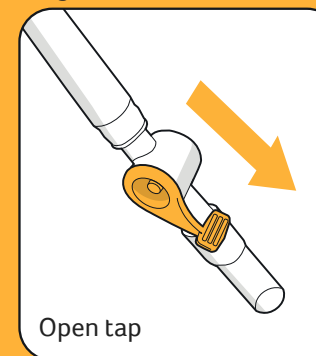
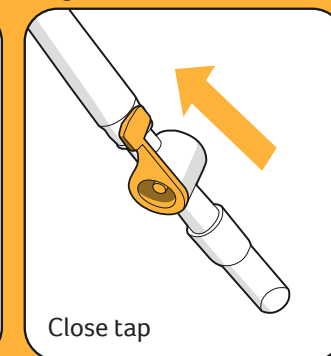

Diagram 3



# Using a Night Stand

It is recommended that you use a night stand or bedside hanger to support the Night Bag in use.

The pre-punched hanger holes on all Great Bear Night Bags allow for the weight of the bag to be equally supported on a Night Stand.

There are two Night Stands available for use at home, the metal 3-in-1 hanger or the Plastic Flat Pack Hanger. Both are available complimentary to patients registered with our Nightingale Home Delivery Service (see page 23).

Please **Freephone 0800 055 6270** for more information.



**Important:** Always position the Night Bag on a night stand at a level below the bladder to ensure optimal drainage



# Key Tips for using a Great Bear Urine Drainage Bag

- Hygiene is of upmost importance when catheterised to prevent infection. Ensure you wash your hands thoroughly before and after handling your Great Bear Drainage Bags. If someone else is handling your Leg or Night Bag, whether that is a Relative, a Carer or Healthcare Professional, they must wash and dry their hands and wear a clean pair of gloves.
- Any Great Bear Drainage Bags that are supplied in an individual peel pouch are sterile. It is important that they remain in their sterile peel pouch until ready for use. If the packaging is damaged or opened, the sterility of the product may be compromised and should not be used.
- Libra Leg Bags and the reusable Night Bags can be kept in situ for 5-7 days. These bags should only ever be disconnected from the Catheter when it needs changing.
- Whilst the graduations on Great Bear Drainage Bags provide a useful indication, they are approximates only and should not be used to record accurate urinary output. If an accurate measurement of volume is required, drain the urine into a clean measuring jug.
- Used Drainage Bags can be disposed of with household waste. Disposable Black Bags are available on request through the Nightingale Home Delivery Service.  
**Do Not** flush your Drainage Bag down the toilet.
- Keep Drainage Bags out of the reach of children – small components could pose a choking hazard.





# Troubleshooting

## **Urine won't drain into my bag?**

Firstly, check that the tubing is not kinked. If there are any kinks in the tubing, straighten them out. A trapped Non Return Valve (NRV) can also prevent urine draining into the bag. The NRV is the clear flap of plastic that is located directly behind the Bear print on the bag. On very 'rare' occasions the NRV during sterilisation can become trapped. Manipulate the NRV by rubbing the front and back of the bag where the Bear is, this should release the NRV and allow proper drainage. If this does not work, please contact your Healthcare Professional.

## **My bag has turned purple?!**

This is a known phenomenon called "Purple Bag Syndrome". Bacteria in the urine or certain medications can react with the bag material and change it blue or purple. The change in colour is not harmful but we would advise you consult your Healthcare Professional to rule out infection.

## **The bag keeps disconnecting from my Catheter?**

Disconnection usually occurs when the connector on the drainage bag has not been sufficiently pushed into the catheter. Ensure the ridged connector on the drainage bag is pushed in as far as possible to ensure a secure connection.

## **The tap on my bag keeps catching/ accidentally opening – what can I do?**

The tap on our Libra Leg Bag and reusable Night Bags can be rotated 360° and positioned to prevent accidental opening.



“It is important to secure the Catheter after insertion to prevent movement & urethral traction”

(EAUN, 2012).



# Importance of Catheter Fixation

The Fix It strap is designed to secure Indwelling and Suprapubic Catheters, as well as Leg Bag tubing with a Sheath System.

Proper securement is essential to prevent urethral trauma, pain and discomfort.

**Do Not** let your Catheter or Drainage Bag hang unsupported. If you are unsure give our customer care team a call who can arrange for samples of supportive devices to be sent to you to secure the Catheter in use.



## Order Codes

### Libra Leg Bag - Prescription

All Prescription Libra Leg Bags come with Fabric Backing and one pair of Leg Bag Straps as standard

Product Code	Capacity	Tube Length	Quantity	PIP Code
10130G	350ml	Direct Inlet	10	361-2991
10100A	350ml	Short (10cm)	10	335-4354
10131H	500ml	Direct Inlet	10	361-3007
10102C	500ml	Short (10cm)	10	335-4388
10104E	500ml	Long (30cm)	10	335-4370
10105F	500ml	Adjustable (45cm)	10	335-4362
10132J	750ml	Direct Inlet	10	361-3015
10106G	750ml	Short (10cm)	10	335-4347
10108J	750ml	Long (30cm)	10	335-4404
10110L	750ml	Adjustable (45cm)	10	335-4396
10133K	1000ml	Direct Inlet	10	361-3023
10120W	1000ml	Long (30cm)	10	342-9453
10122Y	1000ml	Adjustable (45cm)	10	342-9461

### Libra Conform - Prescription

All Prescription Libra Conform come with Fabric Backing and one pair of Leg Bag Straps as standard

Product Code	Capacity	Tube Length	Quantity	PIP Code
10114Q	500ml	Short (10cm)	10	382-4653
10115R	500ml	Long (30cm)	10	382-4661
10116S	750ml	Short (10cm)	10	382-4679
10117T	750ml	Long (30cm)	10	382-4687

### Paediatric - Prescription

All Prescription Mummy, Daddy & Baby Bear come with Fabric Backing and one Leg Bag Strap as standard

Product Code	Capacity	Tube Length	Quantity	PIP Code
10101B	150ml	Direct Inlet	10	384-8306
10125B	150ml	Adjustable (45cm)	10	384-8298
10111M	250ml	Direct Inlet	10	384-8314
10135M	250ml	Adjustable (45cm)	10	384-8322
10103D	350ml	Direct Inlet	10	408-6385
10151D	350ml	Adjustable (45cm)	10	408-6393

# Order Codes

## Single Use Night Bags - Prescription

Product Code	Product Name	Description	Quantity	PIP Code
10300S	GB2	Non Sterile and Non Drainable.	10	335-4339
10303V	GB3	Non Sterile with Single Use T-Tap	10	342-9479
10GB3S	GB3S	Sterile with Single Use T-Tap	10	365-4837
10330Y	GB5	Non Sterile with Single Use T-Tap	10	404-9441

## Reusable Night Bags - Prescription

Product Code	Product Name	Description	Quantity	PIP Code
10400W	GB4	Sterile and reusable with Lever Action Tap	10	335-4321
10402Y	GB4 Fold Up	Sterile and reusable with star tubing and foldable Lever Action Tap	10	385-5137
10430U	GB6	Sterile and reusable with star tubing and Lever Action Tap	10	404-9433

## Notes

This image shows a blank sheet of white paper with horizontal orange lines. The lines are evenly spaced and run across the width of the page, providing a guide for writing. There are no margins, text, or other markings on the paper.

1. Call **Freephone 0800 318 559** or **02920 747 770**.
2. Please ensure you have your GP details to hand.
3. Tell us which products are required and how many.

**That's all - We will do everything else!**

Please make sure you have at least two weeks' supply in hand before re-ordering.

### Complimentary items available:

- Hand Gels
- Radar Keys
- Wet & Dry Wipes
- Disposable Bags
- Night Stands
- Sponge Bag

## **Great Bear Healthcare Ltd**

1 Lambourne Crescent,  
Cardiff Business Park,  
Cardiff, CF14 5GF

**+44 (0)29 2074 7770**

[mail@gbhl.co.uk](mailto:mail@gbhl.co.uk)

[www.greatbearhealthcare.co.uk](http://www.greatbearhealthcare.co.uk)